



STORE FIXTURES

CATALOGUE

Aluminium
Joinery
Systems



CONTENTS

PAGE

Stickman	1
Stickman Radius	2
Stickman Square	3
Stickman Tooling	4
Stickman CNC Machining	5
Stickman Linear	6
18mm Panel Capping	11
Hangshelf	13
Sliding Door System	14
Glass Joining System	16
Glass Cubing	17
Modena Showcases	20
Square Frame	22
Modena Radius Frame	23
Modena Frame Profiles	24
Modena Square Frame	25
Modena Horizontal Beams	27
Glazing Beads	28
Modena Sliding Doors	29
Showcase Shelving	31
Shelf Pins and Door Hinges	32
Locks	33
LED Strip Lighting	34
LED Spotlight System	36
Fabrication Tools	37
Glass Top Specifications	38
Glass Side Panel Specifications	39
Glass Sliding Door Specifications	42
Glass Hinged Door Specifications	43
Frameless Top Front Detail	44

STICKMAN

The STICKMAN range of aluminium profiles and tooling is a growing family that is designed with many benefits for both the fabricator and the end-user. Aluminium corner extrusions fit into a specially machined edge of board to make cabinets/joinery easy to assemble while providing corner protection from chipping. Here are some of the advantages that you will enjoy when you design with the STICKMAN system:

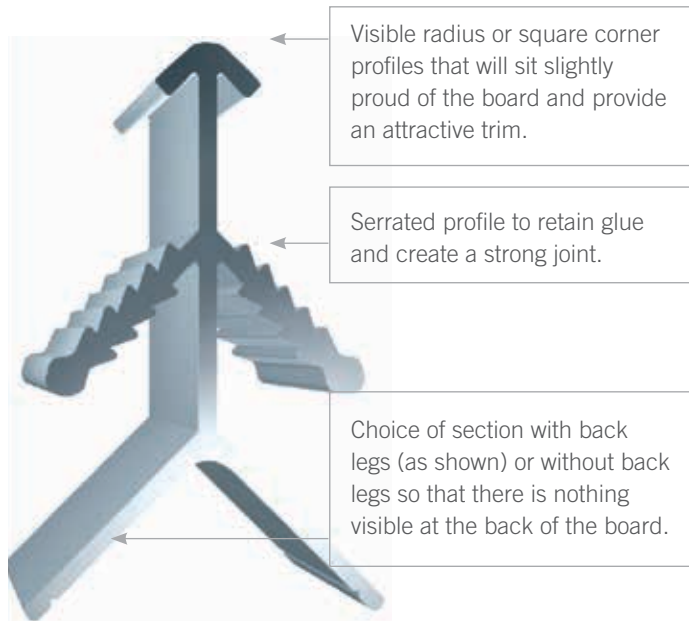

Allows for the use of pre-finished (melamine) board, instead of laminate, reducing the cost.

Reduces skilled labor requirements in factory processes and especially on-site. You will see an increase in manufacturing efficiency while providing a more durable product for your clients.

Only small, unobtrusive aluminium edge visible on the outside corner, while providing full-depth strengthening for the corner joint.

Provides a protective corner that will avoid laminate chipping when it gets knocked by trolleys etc.

Construction of shopfront columns (around roller or folding door openings), or decorative cladding of existing structural columns.

New profiles available provide for a complete wall panelling system with aesthetics and ease of installation in mind.



Call today to receive a sample pack of profiles and machined board samples.



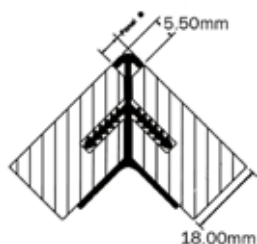

90 DEG. RADIUS CORNER WITH BACK LEGS

- Select the extrusion based on the board thickness.
- Extrusion can be screwed to the back of the board or punched with pneumatic tool for production applications.

Part No.	Panel Thickness	Length	Finish
AP8005A	16mm	5000mm	Clear Anodised
AP8006A	18mm	5000mm	Clear Anodised

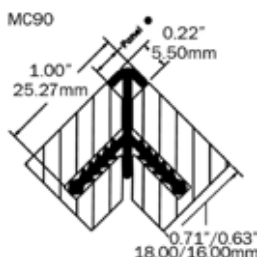

90 DEG. RADIUS CORNER WITHOUT BACK LEGS

- Suits any thickness board.
- No back legs – attach with panel adhesives.

Part No.	Length	Finish
AP8013A	5000mm	Clear Anodised

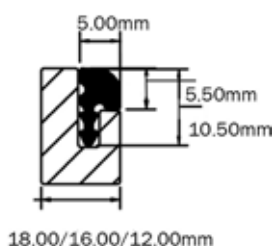
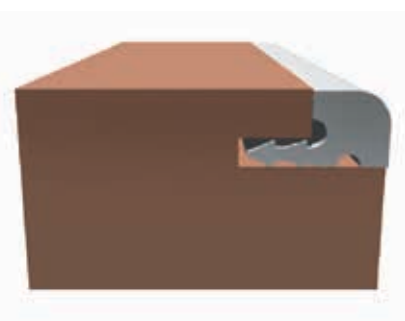

LAMINATE PROTECTOR – RADIUS HEAD

- An economical way of providing protection on laminated corners or mitred joins on a column surround.
- Simply machine with special router cutter, apply small amount of panel adhesive and insert the extrusion.

Part No.	Length	Finish
AP8025/2.5A	2500mm	Clear Anodised
AP8025/3.7A	3700mm	Clear Anodised

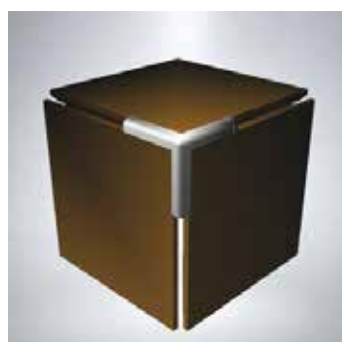

3-WAY MOULDED CORNER

- Hard-wearing plastic corner.
- Eliminates the need for mitring STICKMAN extrusions at 3-way corners.

Part No.	Finish
AP8018	Satin Chrome

135 DEG CORNER

- Suits any thickness board.
- No back legs – attach with panel adhesives.

Part No.	Length	Finish
AP8016	5000mm	Clear Anodised

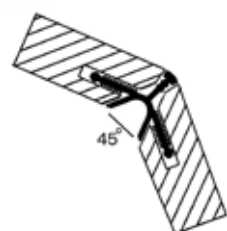

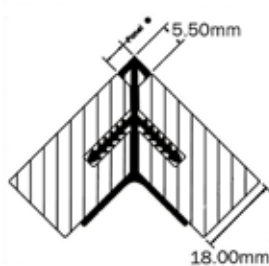

90 DEG. SQUARE CORNER WITH BACK LEGS

- Select the extrusion based on the board thickness.
- Extrusion can be screwed to the back of the board or punched with pneumatic tool for production applications.

Part No.	Panel Thickness	Length	Finish
AP8022A	16mm	5000mm	Clear Anodised
AP8023A	18mm	5000mm	Clear Anodised

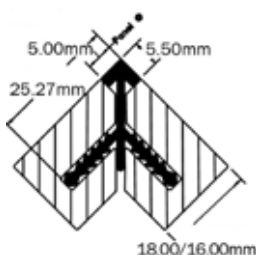

90 DEG SQUARE CORNER WITHOUT BACK LEGS

- Suits any thickness board.
- No back legs – attach with panel adhesives.

Part No.	Length	Finish
AP8004A	5000mm	Clear Anodised

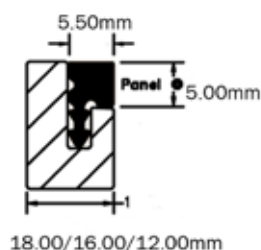
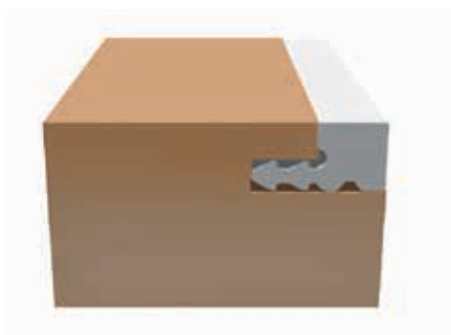

LAMINATE PROTECTOR – SQUARE HEAD

- An economical way of providing protection on laminated corners or mitred joins on a column surround.
- Simply machine with special router cutter, apply small amount of panel adhesive and insert the extrusion.

Part No.	Length	Finish
AP8024/2.5A	2500mm	Clear Anodised
AP8024/3.7A	3700mm	Clear Anodised

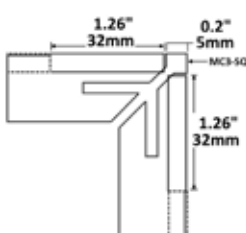

3-WAY MOULDED CORNER

- Hard-wearing plastic corner.
- Eliminates the need for mitring STICKMAN extrusions at 3-way corners.

Part No.	Finish
AP8019	Satin Chrome

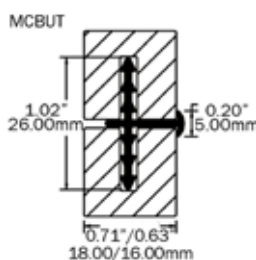
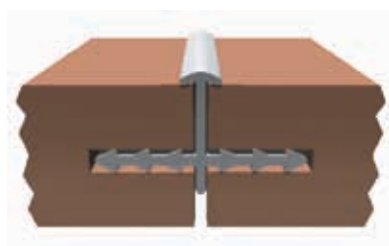

PANEL JOINER

- Used for creating perfect alignment at the front face of any thickness board.
- Finned centre arms to retain adhesive.

Part No.	Length	Finish
AP8020A	5000mm	Clear Anodised



SINGLE-PASS ROUTER CUTTER

- Use with hand-held or bench router for all corner sections.
- 12.7mm dia. Shank.
- Max RPM – 12,000

Part No.	Shank
AP8015	12.7mm



SLOTING CUTTER FOR PANEL JOINER

- For use with AP8020A and AP8008A sections.

Part No.	Shank
AP8021	12.7mm



SLOTING CUTTER FOR LAMINATE PROTECTOR

- For use with AP8024 and AP8025 sections.
- 12.7mm dia. Shank.
- Max RPM – 12,000

Part No.	Shank
AP8026	12.7mm



GLUE GUN & ADHESIVE

- Specially formulated adhesive for STICKMAN profiles into machined board.

Part No.	Size	Ctn Qty
AP8035	600ml Sausage	20
AP8036	Caulking Gun	12
AP8037	Replacement Nozzle	50
AP8038	Replacement Plunger	1 00



PNEUMATIC PUNCH

- Pneumatic punch for rapid assembly process of STICKMAN profiles with legs. Holds sections in place while adhesive dries.

Part No.
AP8040

Now your STICKMAN profiles can be simply machine on a flatbed CNC router that enables your machine panels around all 4 sides in a nested configuration.

We have developed specific tooling to make this possible and increase your efficiency and production output.



ROUTER SET FOR CNC MACHINING

- Use with CNC router for volume production.
- 12.7mm dia. Shank.
- Max RPM – 12,000

Part No.	Shank	Part
AP8031	12.7mm	45 Deg Cutter
AP8032	12.7mm	Slotting Cutter
AP8033	Replacement cutter for AP8031	
AP8034	Replacement cutter for AP8032	

1. Use 9.5mm upper cut cutter.
Cut along outside of geometry line.
Cut 16mm deep.

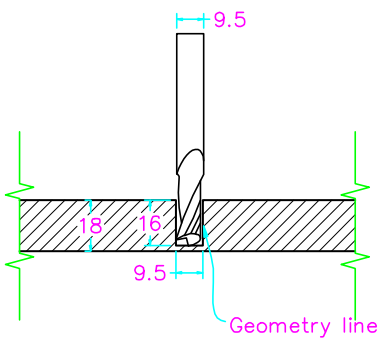

2. Use 45° Vee shape cutter.
Outward offset 1mm geometry line.
Cut on offset line.
Cut 16mm deep in 2 steps.
(Last cut is 5mm)

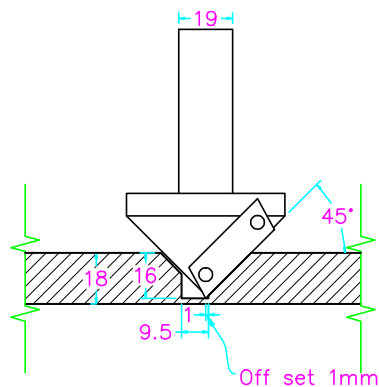

3. Use 51mm groove cutter.
Groove 22.5mm inside from geometry line.
3.2mm groove in middle of 18mm panel.

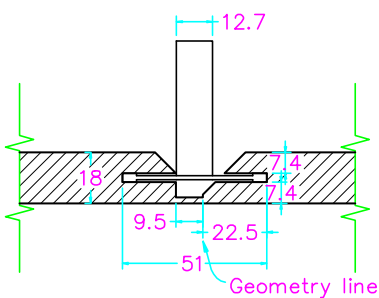

4. Use 9.5mm upper cut cutter.
Cut along outside of geometry line.
Cut 18.2mm deep right through panel.

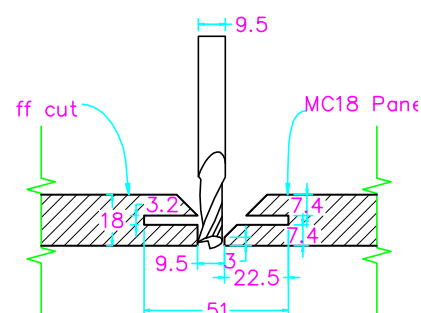

STICKMAN LINEAR is a complete suite of new profiles designed specifically for the wall panelling market. These profiles provide for easy & precise installation with simple machining procedures.

- Panels can be pre-machined in the factory. Alterations, if necessary, can be simply accomplished on-site with basic power tools.
- Matching end capping profiles are available to finish off around doorways and openings, creating a completely homogenous system.
- STICKMAN LINEAR is perfect for commercial applications such as hotels, hospitals & healthcare facilities where the aesthetics of decorative panelling can be combined with the corner & edge protection that the system can provide.
- Our new profiles from the STICKMAN LINEAR range allow you to fix directly to wall studs without the need of a supporting wall panel behind. This offers a much faster installation method and can potentially eliminate an area that has traditionally required "wet trades". We look forward to discussing ways to save time and money on your next fitout project.

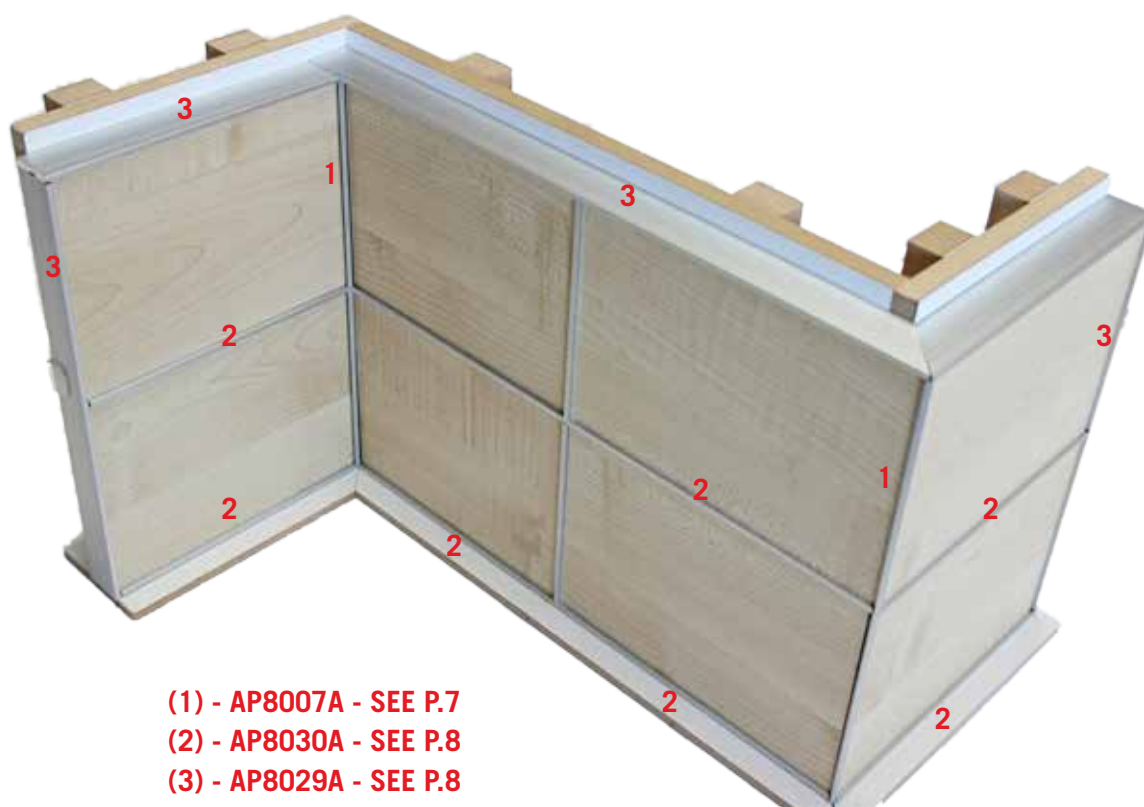

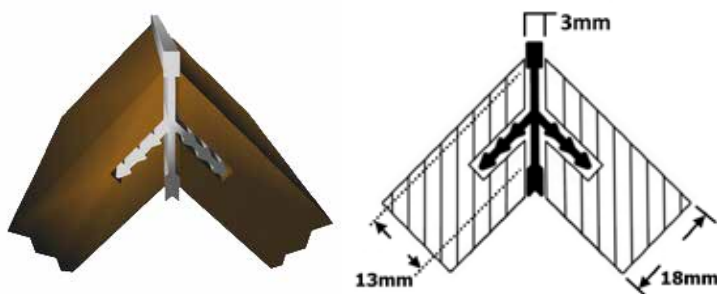

90 DEG CORNER WITH FLAT EDGE

- Used for creating perfect corner alignment with a 3mm thick flat edge facing out.
- Finned centre arms to retain adhesive.

Part No.	Length	Finish
AP8007A	5000mm	Clear Anodised

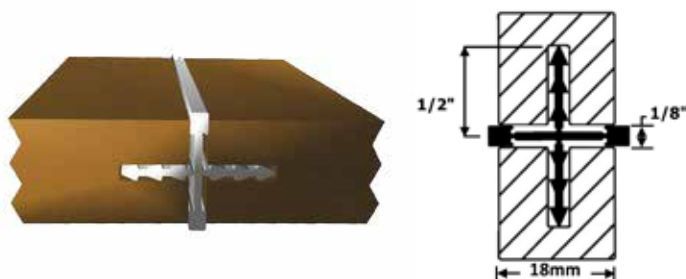

PANEL JOINER WITH FLAT EDGE

- Used for creating perfect alignment at the front face of any thickness board.
- Finned centre arms to retain adhesive.
- Fins removable by cutting and breaking off (see diagram).

Part No.	Length	Finish
AP8008A	5000mm	Clear Anodised

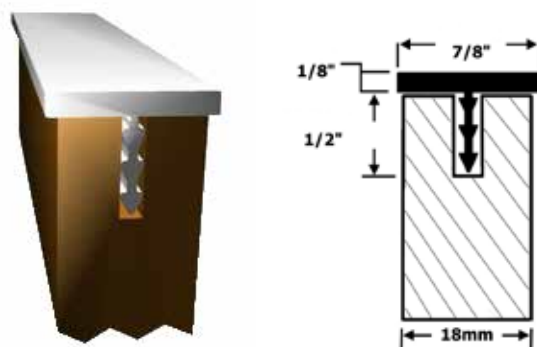

PANEL END CAP WITH FLAT EDGE

- Used for creating the perfect end finish to match.
- Finned centre arms to retain adhesive.

Part No.	Length	Finish
AP8009A	5000mm	Clear Anodised

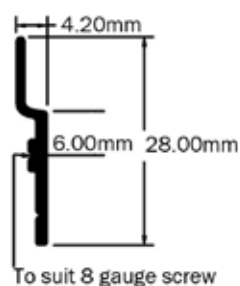

SMALL ALUMINIUM SPLIT BATTEN

- Light-weight extrusion for simple attachment of smaller pre-cut panels.
- Overall thickness – 4mm.

Part No.	Length	Finish
AP4222	2400mm	Mill Finish

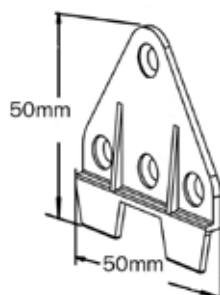
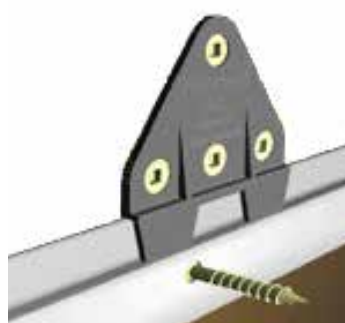

SPLIT BATTEN CLIP

- Our range of common angles are a convenient solutions for various finishing options.

Part No.	Finish
AP4227	Black Plastic

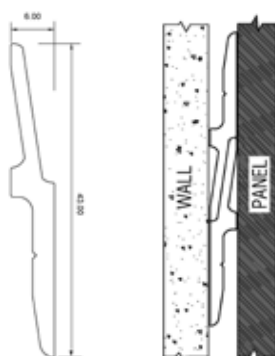

LARGE SPLIT BATTEN

- Heavy duty aluminium section for larger panels.
- Includes pre-drilled mounting holes.
- Gap-wall-back of panel-6mm

Part No.	Length	Finish
AP6503	2500mm	Mill Finish

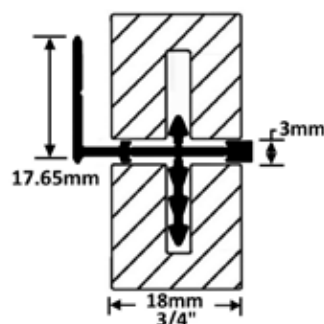

DIRECT WALL FIX LARGE SPLIT BATTEN

- Provides simple combination of wall-mounting and joining profile.
- Incorporates "breakline" to simply snap off the top or bottom finned section.

Part No.	Length	Finish
AP8030A	5000mm	Anodised

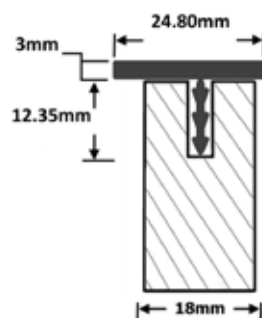

WALL FIX CAP

- Used for creating the perfect end when used in combination with AP8030A.

Part No.	Length	Finish
AP8029A	5000mm	Anodised

16/18MM THICK PANEL DETAIL

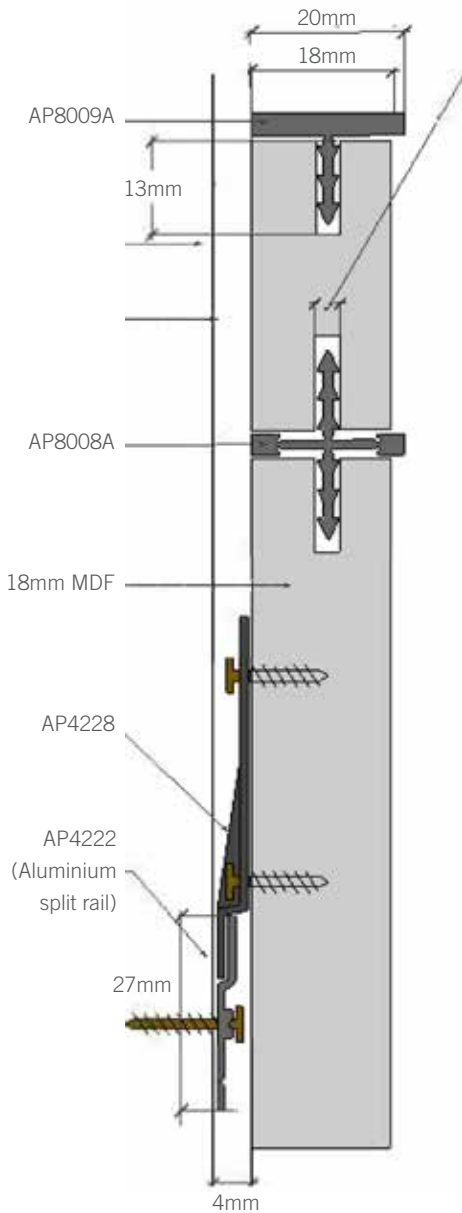

12MM THICK PANEL DETAIL

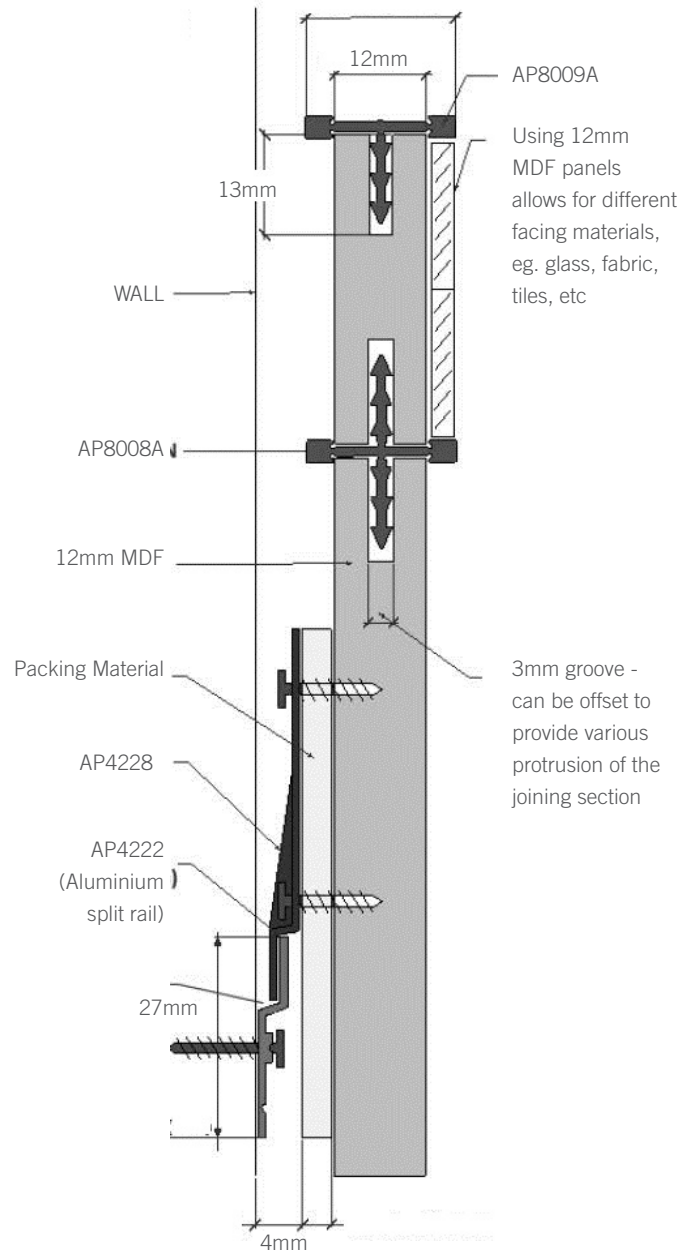

- You can combine different thicknesses panels in the same installation. Maintain the position of the aluminium joining section by machining all panels from the back.
- Additional space can be created behind the panel for electrical conduits, etc by mounting a packing piece on the rear of the panel.

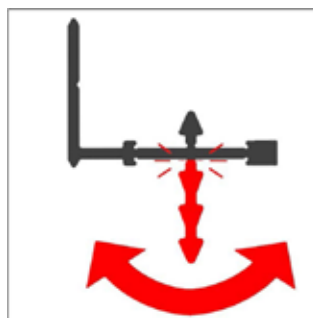
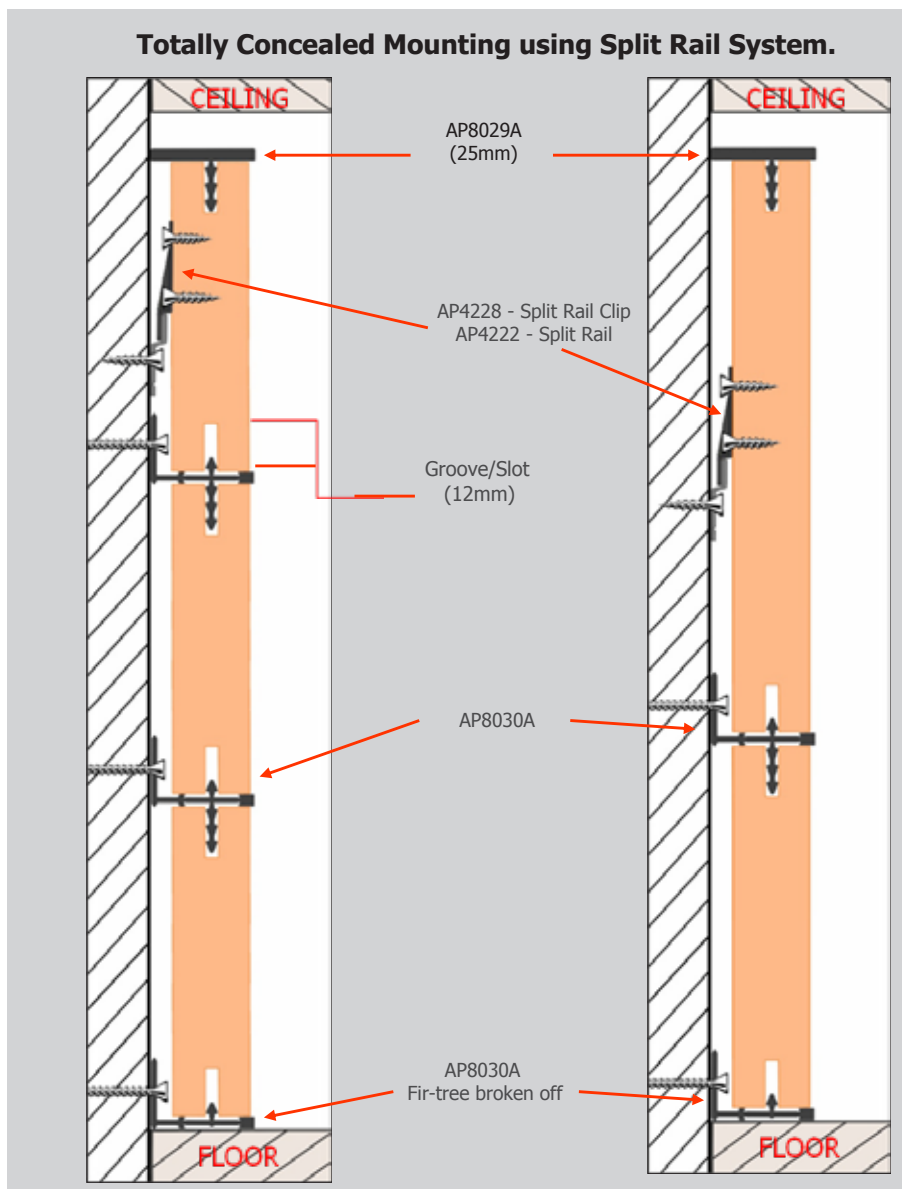

View of corner showing the horizontal wall-mounting section - AP8030A - mitred & notched to fit around vertical corner - AP8007A.

Notching of corner is simply achieved by making a saw cut from the back and snapping off along the breakline.



18MM PANEL CAPPING SYSTEM

- A low-profile, easily installed capping system for 18mm thick panels.
- Moulded vertical & horizontal corners eliminate the need for sharp mitred corners.
- Concealed fixing by means of a plastic clip that gets fixed onto the panel edge.



ALUMINIUM CAPPING

- A low-profile, easily installed capping system for 18mm thick panels.
- Cross section – 20mm x 10mm.

Part No.	Length	Finish
AP4408A	5000mm	Clear Anodised



CAPPING ATTACHMENT CLIP

- Concealed fixing by means of a plastic clip that gets fixed onto the panel edge.
- Attach to end of panels with screws or staples at every 300mm (approx).
- End capping simply snaps onto the clip.

Part No.	Finish
AP4403	Black Plastic



VERTICAL CORNER

- Moulded vertical corners eliminate the need for sharp mitred corners.

Part No.	Finish
AP4409A	Silver plastic



HORIZONTAL CORNER

- Moulded horizontal corners eliminate the need for sharp mitred corners.

Part No.	Finish
AP4407A	Clear Anodised

**ALUMINIUM 'U' CHANNEL**

- Provides excellent method to finish off panel ends.
- Can be mitred to fit around all 4 sides of the panel.
- External size - 22mm wide x 25mm high.

Part No.	Length	Finish
AP4224A	5000mm	Clear Anodised

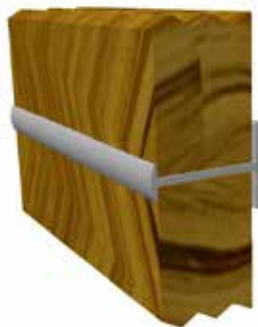
**ALUMINIUM 'H' JOINER**

- Covers small discrepancies between panel joints.
- May be used either way depending on coverage required.

Part No.	Length	Finish
AP4223	2400mm	Mill Finish

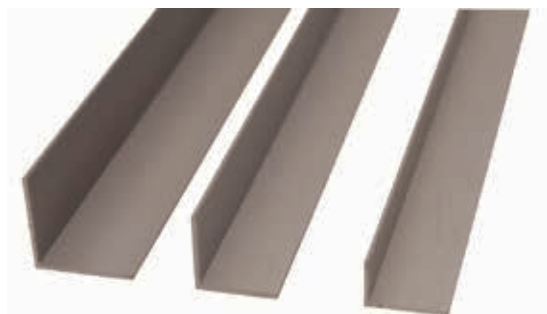
**ALUMINIUM ANGLES**

- Our range of common angles are a convenient solutions for various finishing options.

Part No.	Size	Length	Finish
AP9210A	25 x 25mm	6500mm	Clear Anodised
AP9215A	20 x 20mm	6500mm	Clear Anodised
AP9216A	20 x 12mm	6500mm	Clear Anodised

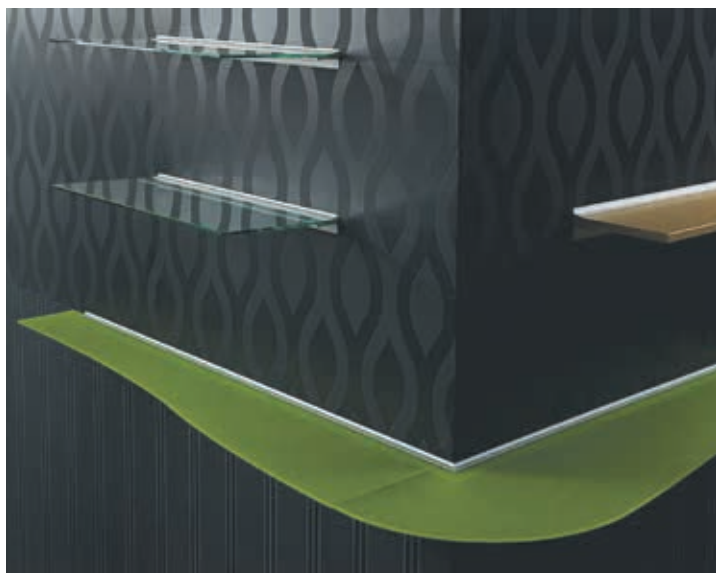

HANGSHELF BRACKETLESS SHELVING

- Create some amazing shelving situations with this unique range of aluminium extrusions that allow shelves to be cantilevered from the wall, becoming almost invisible.
- Different extrusions cater to most common shelving thicknesses.

***** When fixing into stud framed walls, the Hangshelf extrusion must be screwed directly to the studs *****

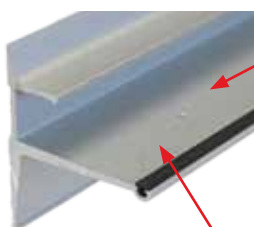
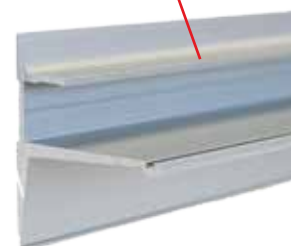
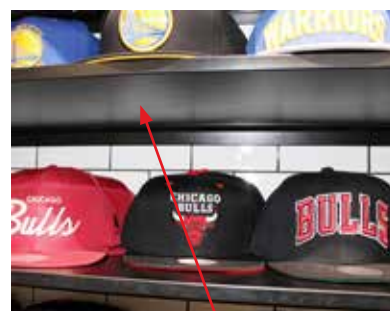

6MM HANGSHELF

- To suit 6mm thick glass/melamine shelves.
- Optional insert attaches to front of shelf and provides extra security from shelf becoming dislodged.

Part No.	Length	Finish
AP8250/5A	5000mm	Clear Anodised
AP8250/M	Per Metre	Black PVC

16MM HANGSHELF

- To suit 16mm thick glass/melamine shelves.
- Use PVC insert (above) for additional shelf support.

Part No.	Length	Finish
AP8255/5A	5000mm	Clear Anodised
AP8250/M	Per Metre	Black PVC

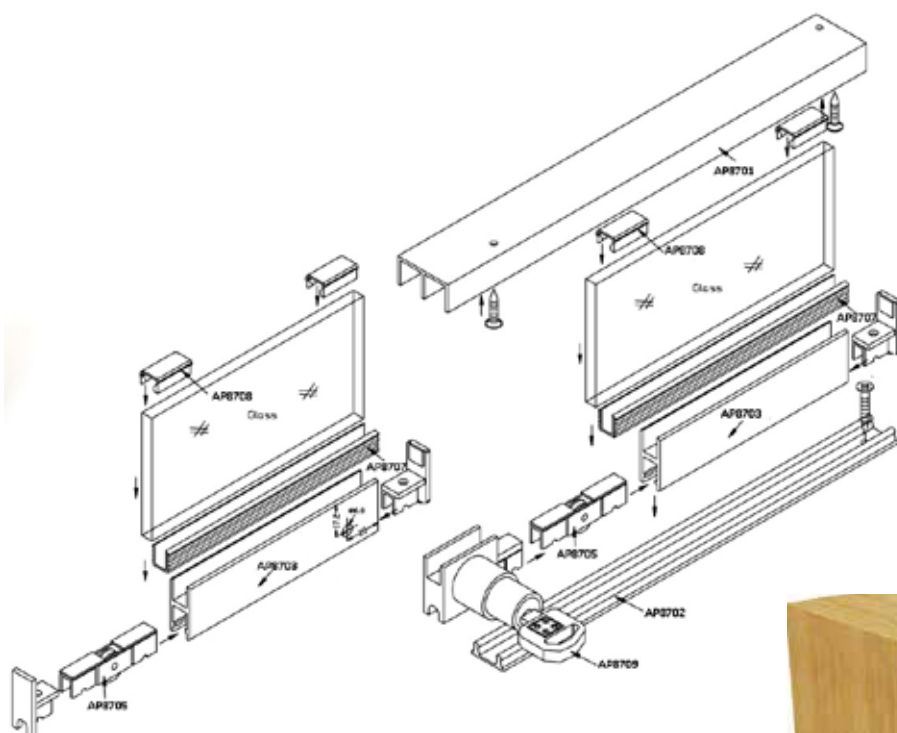

- Our new sliding door system contains all the components to simply install glass or acrylic sliding, lockable doors into any opening.
- Locks and handles are fitted to the track and allow full functionality of operation without the expense of glass drilling.
- Precision machined wheel assemblies lock themselves into the track and provide exceptionally smooth running.
- Suitable for doors of up to 1.5 sq. mtrs. per panel.



ALUMINIUM TOP RACK

- May also be used as a side trim for vertical sides.

Part No.	Length	Finish
AP8701	3800mm	Anodised

ALUMINIUM BOTTOM RACK

- May also be used as a side trim for vertical sides.

Part No.	Length	Finish
AP8702	3800mm	Anodised

ALUMINIUM GLASS RAIL

- Attached to glass with AP8707 moulding - no adhesive necessary.

Part No.	Length	Finish
AP8703	3800mm	Anodised

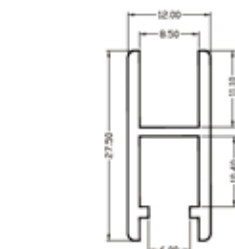
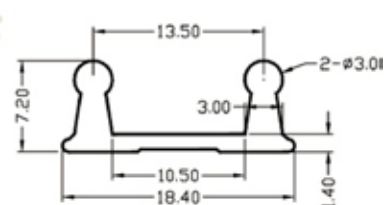



- Slides securely into the Glass Rail.
- Heavy-duty steel ball bearing.

Part No.	Length	Finish
AP8705	-	Zinc



- Provides friction fit of glass panel to the AP8701 Glass Rail.

Part No.	Length	Finish
AP8707	100mtr	Grey PVC
AP8707/M	Per Mtr	Grey PVC



- Ensures silent running of glass doors in top track.
- Use 2 pieces per door.

Part No.	Length	Finish
AP8708	30mm	Clear Plastic



- Slides into the end of AP8703 Glass Rail and over the glass door.

Part No.	Length	Finish
AP8706	-	Chrome



- Tightens into end of AP8703 Glass Rail.
- Requires hole drilled into rear Glass Rail for pin plunger - suggested hole size - 8mm diameter.

Part No.	Length	Finish
AP8709DIF	Keyed to differ	Chrome
AP8709KA	Keyed alike	Chrome

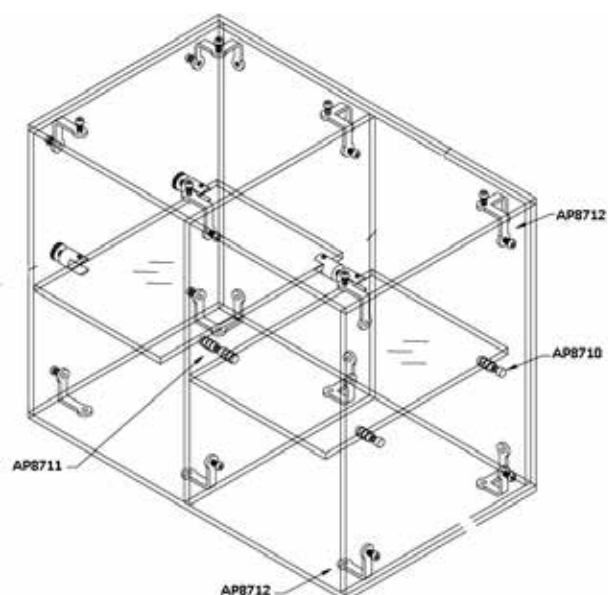

- This range of connectors will amaze you with the possibilities that are opened up by allowing you to create a wide range of frameless fixtures in glass or similar materials and supply as a flat-packed unit.
- Works on material with 5-8mm thickness.
- Incorporate shelf pegs into pre-drilled holes to complete the range of possibilities.

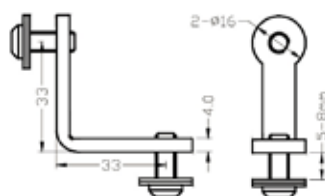

2-WAY CONNECTOR

- For glass thickness 5-8mm.
- Suggested hole diameter - 7mm.

Part No.	Length	Finish
AP8712	-	Chrome

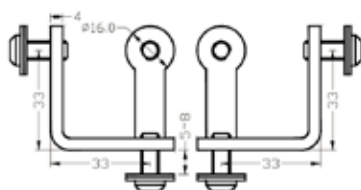

3-WAY CONNECTOR

- For glass thickness 5-8mm.
- Suggested hole diameter - 7mm.

Part No.	Length	Finish
AP8713	-	Chrome

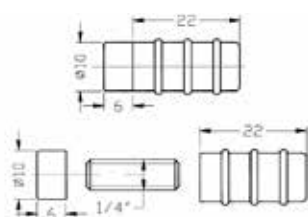

SHELF SUPPORTS

- Use single-sided support for ends and double-sided supports for centre dividers.
- Suggested hole diameter - 7mm.

Part No.	Length	Finish
AP8710	Single-sided	Chrome
AP8711	Double-sided	Chrome

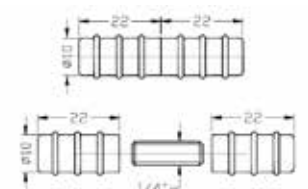



GLASS CUBING COMPONENTS

- Now you can create your own glass cubing structure by mix and matching our range of standard glass and chrome connectors.
- Glass cubing has proven itself to be an effective method of displaying merchandise from Manchester, clothing and giftware to motorcycle helmets, etc.
- Our glass cubing components are designed to work with 5mm thick glass.



SQUARE GLASS PANELS

- 5mm thick, clear toughened glass with polished edges.

Part No.	Size
AP4195	448mm x 448mm



RADIUS GLASS PANELS

- Use for radiussed ends or tops.
- 5mm thick toughened glass with polished edges.

Part No.	Size
AP4200	448mm x 448mm



2-WAY 'L' CONNECTOR

- With nylon tightening screws.

Part No.	Finish
AP670	Chrome

**3-WAY 'T' CONNECTOR**

- With nylon tightening screws.

Part No.	Finish
AP671	Chrome

**4-WAY CROSS CONNECTOR**

- With nylon tightening screws.

Part No.	Finish
AP672	Chrome

**HINGE**

- With nylon tightening screws.
- Pair of fittings.

Part No.	Finish
AP675	Chrome

**HASP**

- With nylon tightening screws.
- Pair of fittings.

Part No.	Finish
AP676	Chrome

**PADLOCK**

- Mini padlock for use with hasp.

Part No.	Finish
AP7029	Chrome

**3-WAY ADJUSTABLE CONNECTOR**

- With nylon tightening screws.
- Allows for adjustable shelf heights or continuous glass partitions.

Part No.	Finish
AP677	Chrome

**4-WAY ADJUSTABLE CONNECTOR**

- With nylon tightening screws.
- Allows for adjustable shelf heights or continuous glass partitions.

Part No.	Finish
AP678	Chrome

**2-WAY 120 DEG. CONNECTOR**

- With nylon tightening screws.

Part No.	Finish
AP673	Chrome

**3-WAY 120 DEG CONNECTOR**

- With nylon tightening screws.

Part No.	Finish
AP674	Chrome

- The versatility of the MODENA system from ADP STORE FIXTURES allows you to create stunning display solutions for the retail, commercial & high-end residential markets. Using 1 single system, we can construct multiple display configurations in a variety of sizes, formats & finishes.
- The aim is to make sure that the product stands out from the crowd and creates an engaging experience to maximise customer interaction.
- From retail counters, towers to very large installations, our experienced design team works with designers, fabricators and retailers to meet their individual needs. We are happy to provide individual components or you can draw on our extensive experience in assembling & installing complete units in complex installations.
- The basic elements consist of profiles, connectors & accessories. The investment that has been made by ADP in modular componentry permits simple assembly of complete structures for a vast range of applications.
- You can increase the effectiveness of your showcase display through our comprehensive range of lighting systems using the latest in LED designs and technology. Our lighting products provide you with a wide choice of possibilities from overall lighting using LED strip lighting or directional spotlights for specific product illumination. All of our lighting solutions combine the advantages of long-life & low-heat operation with excellent colour rendition.
- Our profiles are mostly stocked in Natural Anodised aluminium for immediate use. However, we can provide a full range of powdercoat colour options to fit in with your design theme.

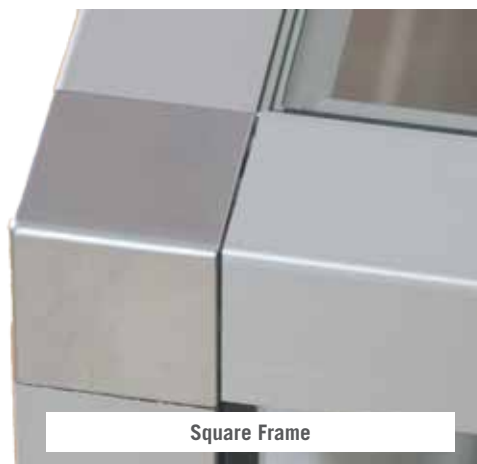

Square Frame



Radius Frame



Frameless Top Options



Lighting Options

THE SHOPFITTER'S CHALLENGE

- At ADP, we understand the nature of the shopfitting industry with its demanding lead times and unique set of challenges involved in getting shop's opened by a strict deadline.
- We have been assembling showcases for many years and can assist you in the design process to achieve the result that you are seeking to achieve.
- As a further step, we can produce the complete showcase for you, ready to install, either as a free-standing unit or incorporated into cabinetry by others - our system can provide accuracy within a couple of millimeters over a long length. This ensures that you can concentrate on the overall project without having to divert specialist resources that would be at a premium.
- The examples on this page are examples of what we have produced for various shopfitter clients throughout Australia. We are specialist in the packaging and transport of showcases so that they reach their destination in pristine condition.



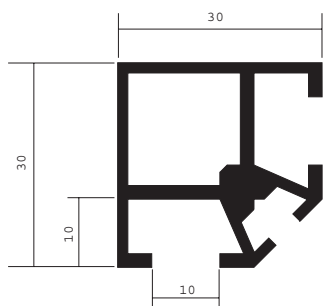

SQUARE FRAME

Part No.	Length	Finish
AP8801A	5000mm	Clear Anodised
AP880/M	5000mm	Mill



3-WAY SQUARE CORNERS

Part No.	Finish
AP8811SL	Silver Powdercoat
AP8811M	Raw



2-WAY SQUARE CORNER

- Allow for use with frameless top/sides.

Part No.	Finish
AP8812SIL	Silver Powdercoat



PLASTIC END CAP

Part No.	Finish
AP8831GY (Top)	Grey Plastic with M6 metal thread for levellers
AP8832GY (Bottom)	Grey Plastic with M6 metal thread for levellers
AP8844/M6	Black Plastic with M6 metal thread for levellers



THREADED INSERT & LEVELLER

- Heavy-duty insert with M8 metal thread.
- Can be used with leveller and casters.
- Fits into AP8801 & AP8804 & AP8802

Part No.	Part	Finish
AP8839	Threaded Insert	Black Plastic
AP8844/M8	Leveller	Black Plastic

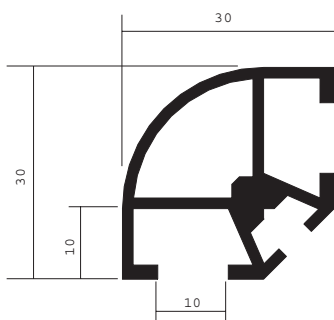
**RADIUS FRAME**

Part No.	Length	Finish
AP8803A	5000mm	Clear Anodised

3-WAY RADIUS CORNER

Part No.	Finish
AP8813SIL	Silver Powdercoat
AP8813M	Raw

2-WAY RADIUS CORNER

Part No.	Finish
AP8812SC	Silver Powdercoat

PLASTIC END CAPS

- AP8834 with metal thread to suit M6 leveller.

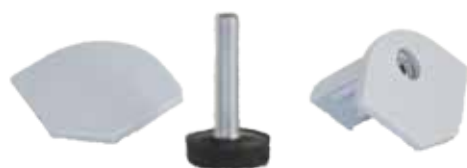

Part No.	Finish
AP8833GY (Top)	Grey Plastic
AP8834GY (Bottom)	Grey Plastic with M6 metal thread for levellers
AP8844 (Leveller)	Black Plastic with M6 metal thread

GLASS CUSHION

- Provides safety cushion between glass & aluminium.
- Flexible plastic with fold-up flaps to fit tightly into extrusion.

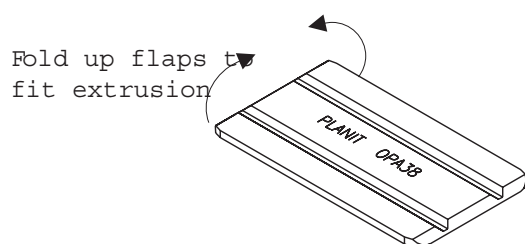

Part No.	Finish
AP8848	Clear Plastic

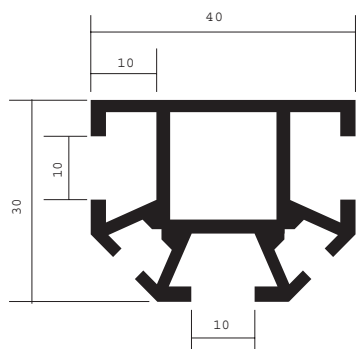

MULLION

Part No.	Length	Finish
AP8804A	4000mm	Clear Anodised

PLASTIC END CAPS

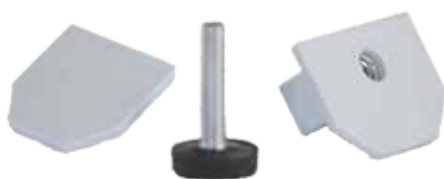

Part No.	Finish
AP8835GY (Top)	Grey Plastic
AP8836GY (Bottom)	Grey Plastic with M6 metal thread for levellers
AP8844 (Leveller)	Black Plastic with M6 metal thread

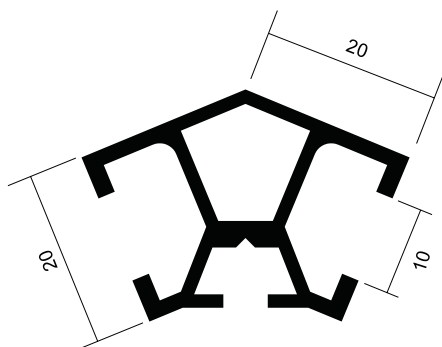

135 DEG. FRAME

- Includes rear track for shelf supports.

Part No.	Length	Finish
AP8807A	5000mm	Clear Anodised

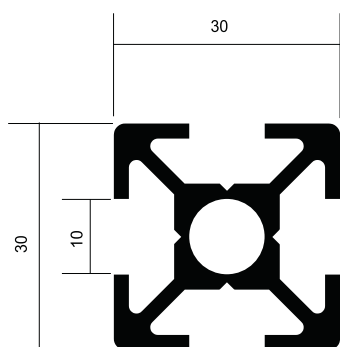

4-WAY SQUARE FRAME

Part No.	Length	Finish
AP8806M	5000mm	Mill Finish



ANGLE BRACE

- Reinforcing of corner joints.

Part No.	Finish
(1) AP8826	Aluminium
(2) AP8817	Steel

(For re-inforcing of mitred joints)



- With our new 40 x 40mm square frame section, you get amazing versatility for fabricating a wide range of structures that can be supplied in pre-cut and machined lengths and simply assembled on-site.
- Standard beam lock assembly provides secure fastening with the quarter turn of an Allen key.
- The square frame system is perfectly compatible with all standard showcase components, allowing you complete versatility to incorporate various panels, lighting or details into your designed structure.

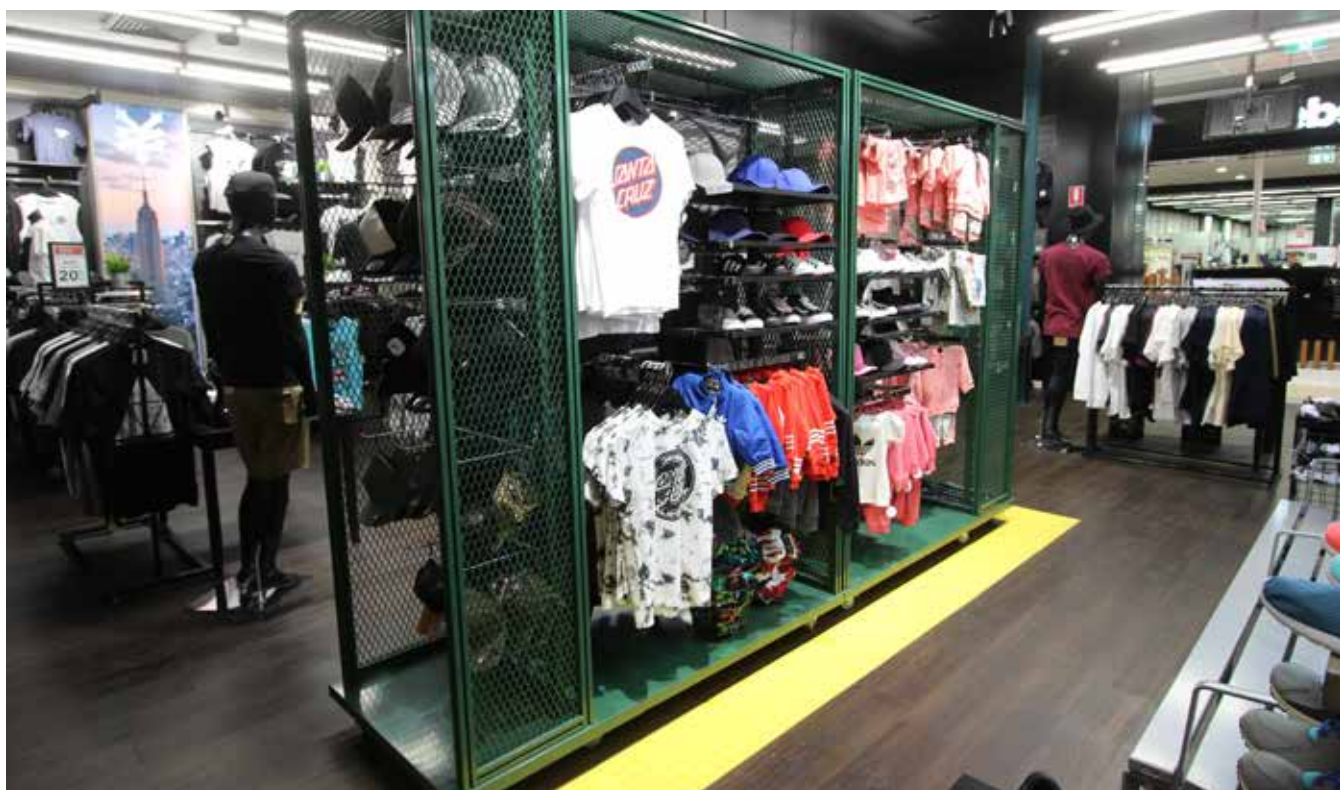

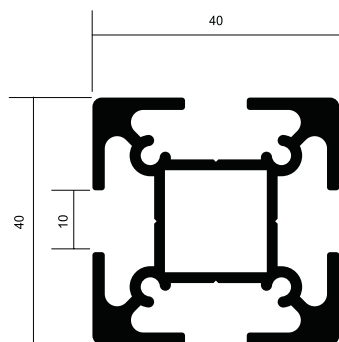

4-WAY SQUARE FRAME (LARGE)

- Ideal solution for constructing heavy-duty frames using this section and Metal Beam Locks

Part No.	Length	Finish
AP8802A	5000mm	Anodised



METAL TOP CAP

- For AP8802 section - fixes with 4 off 8g x 38mm CSK self-tapping screws.

Part No.	Finish
AP8888	Clear Anodised

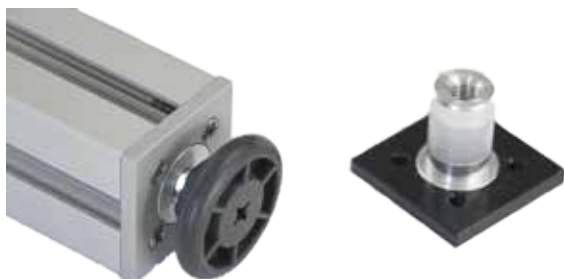

THREADED METAL BOTTOM CAP

- For AP8802 section - fixes with 4 off 8g x 38mm CSK self-tapping screws. Has M8 thread for caster or leveller.

Part No.	Finish
AP8889	Clear Anodised



SLIDING NUT

- Simple method of attaching fixtures to the framing section. M5 thread.

Part No.	Finish
AP8818	-



METAL BEAM LOCK

- New design lock for joining beam sections at 90°.
- Simple half turn to unlock.

Part No.	Finish
AP8810	Clear Anodised

SINGLE TRACK BEAM

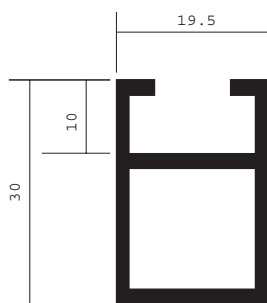

Part No.	Length	Finish
AP8816A	5000mm	Clear Anodised

2-TRACK BEAM

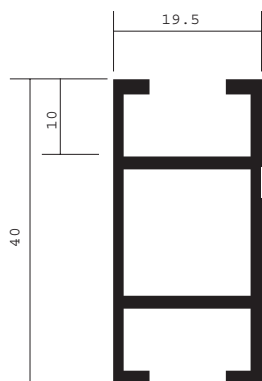

Part No.	Length	Finish
AP8819A	5000mm	Clear Anodised

2-TRACK BEAM WITH LIP

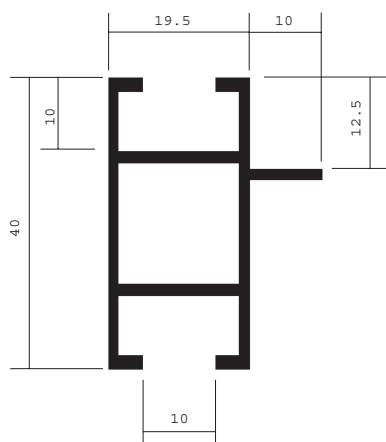

Part No.	Length	Finish
AP8805A	5000mm	Clear Anodised

2-TRACK LARGE BEAM

- Uses 2 beam locks on each end for extremely strong joints.

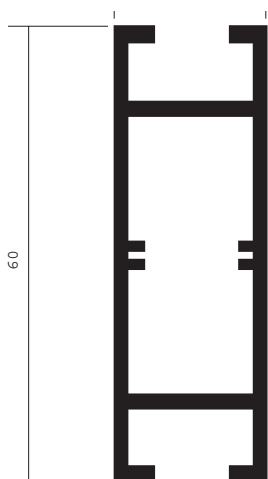

Part No.	Length	Finish
AP8828A	5000mm	Clear Anodised



- 4mm thick glass
- Colour strip yellow



- 6mm thick glass
- Colour strip blue

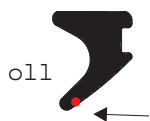

- 5mm thick glass
- Colour strip red

GLAZING BEADS

Part No.	Colour Strip	Length	Suits Glass
AP8821	Yellow	200mtr	4mm
AP8821M	Yellow	per mtr	4mm
AP8822	Red	250mtr	5mm
AP8822M	Red	per mtr	5mm
AP8823	Blue	300m	6mm
AP8823M	Blue	per mtr	6mm

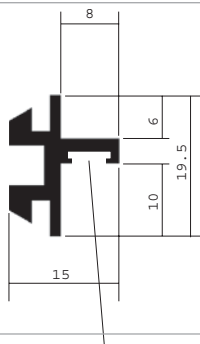

ALUMINIUM FLUSH TOP/DOOR STOP

- Use as a stop for hinged doors or as a flush top support for counter glass tops.
- AP8827 slides into AP8854 as door cushioning stop.

Part No.	Length	Finish
AP8854A	4000mm	Clear Anodised



FUR STRIP

- AP8827 slides into AP8854 as door cushioning stop.

Part No.	Length	Finish
AP8827	per mtr	Black



ALUMINIUM TRACK FILLER

Part No.	Length	Finish
AP8856A	5000mm	Clear Anodised

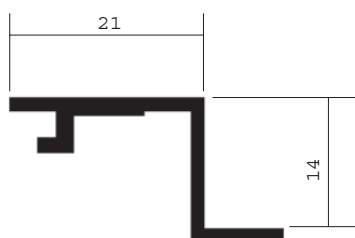

TOP CAP WITH LIP - SINGLE-SIDED

Part No.	Length	Finish
AP8850M	4000mm	Mill Finish

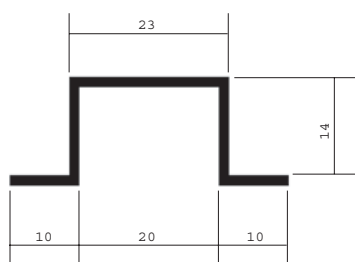

TOP CAP WITH LIP - DOUBLE-SIDED

Part No.	Length	Finish
AP8851M	4000mm	Mill Finish

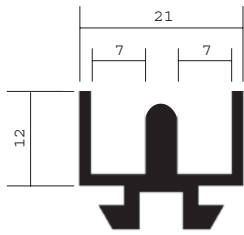
**SLIDING DOOR TOP TRACK**

- Also used as bottom track with track filler strip for non-roller glass sliding doors.

Part No.	Length	Finish
AP8860A	4000mm	Clear Anodised
AP8820 (Track Filler)	4000mm	Black

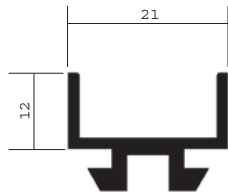
**SLIDING DOOR VERTICAL TRIM**

- Use to cover side frame of sliding doors or to take 18mm thick timber panels.

Part No.	Length	Finish
AP8861A	4000mm	Clear Anodised

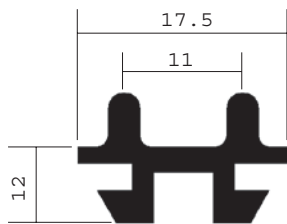
**SLIDING DOOR BOTTOM ROLLER TRACK**

- Suits any thickness board.
- No back legs – attach with panel adhesives.

Part No.	Length	Finish
AP8862A	4000mm	Clear Anodised

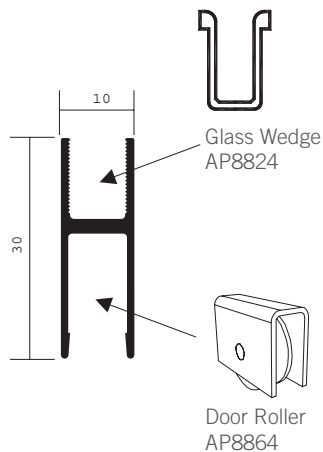
**SLIDING DOOR GLASS RAIL**

Part No.	Length	Finish
AP8863A	4000mm	Clear Anodised
AP8824 (Glass Wedge)	100mtr	Clear PVC
AP8824/M	per mtr	Clear PVC
AP8864 (Door Roller) Minimum 2 per door	-	Zinc

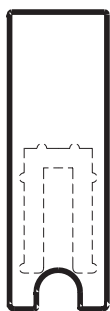

PVC END CAP

- For AP8863 glass rail.

Part No.	Finish
AP8838	Grey PVC

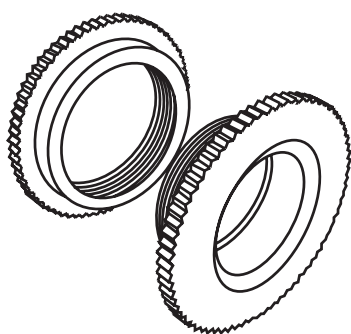

FINGER PULL

- 2-Piece design tightens onto 6mm thick glass.
- Fits 21mm hole dia.

Part No.	Finish
AP8868	Chrome

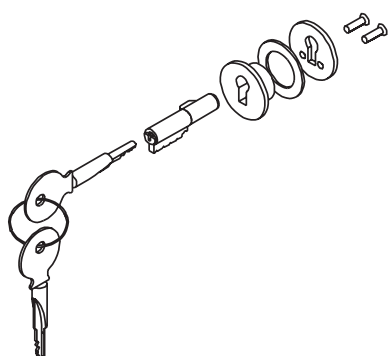

SLIDING DOOR LOCK

- Universal plunger lock. Fits into 17mm dia. Door hole.

Part No.	Finish
AP8842	Chrome

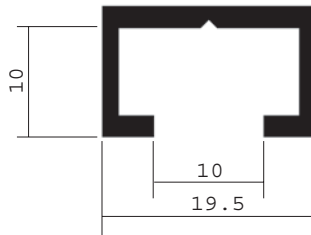

(1) ALUMINIUM LIPPED CHANNEL/WALL TRACK

Part No.	Length	Finish
AP8852A	4000mm	Clear Anodised

(2) ALUMINIUM SLOTTED STRIPPING

- Slides into wall track – AP8852, Slot pitch – 40mm.

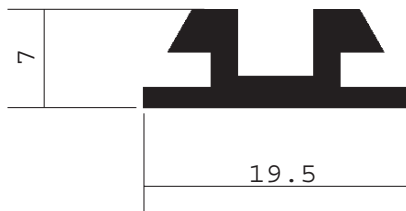

Part No.	Length	Finish
AP8856A	4000mm	Clear Anodised

(3) SLOTTED STRIPPING SUPPORT CLIP

- Use for supporting wall track (AP8852) & slotted stripping (AP8856).
- Slides into angle track on AP8801/3 at top and/or bottom.

Part No.	Finish
AP8846	Grey Plastic

**(4) SLOTTED STRIPPING BOTTOM SUPPORT**

- Use for supporting wall track (AP8852) & slotted stripping (AP8856).
- Fits into 5mm dia. Hole in base board at bottom of showcase.

Part No.	Finish
AP8847	Grey Plastic

SLOTTED SHELF BRACKETS WITH LIP

- For glass shelves. Use 4 x AP5767 suction cups per pair of brackets

Part No.	Length	Finish
AP6581C	300mm	Chrome
AP6583C	400mm	Chrome
AP5767	Suction Cup	Clear



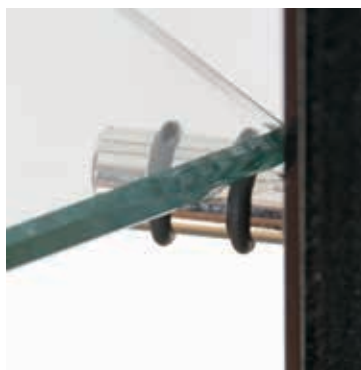

SHELF PEG - STANDARD

- 3-piece threaded peg can be inserted anywhere into the frame and tightened up.
- Includes rubber grommets for cushioned shelf rest.

Part No.	Finish
AP8825	Chrome



SHELF PEG - HEAVY

- Expanding aluminium fitting can be inserted anywhere into the frame and tightened up.
- The clear plastic shelf rest clips over the peg and prevents shelf movement.

Part No.	Finish
AP8870	Aluminium
AP8871	Clear Polycarbonate



GLASS DOOR PIVOT HINGE - STANDARD

- Standard pivot hinge mounts to top & bottom of glass door.
- Sold in pairs – 1 set per door.

Part No.	Finish
AP8840	Chrome

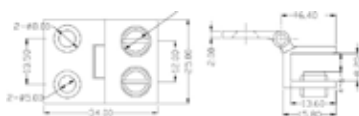

SIDE-MOUNT HINGE

- Mounts to sided of glass door, allowing for multiple hinges to be used on larger glass doors.
- Sold each.

Part No.	Finish
AP8841	Chrome



HEAVY-DUTY SIDE-MOUNT HINGE

- Mounts to sided of glass door, allowing for multiple hinges to be used on larger glass doors.
- Sold in pairs.

Part No.	Length	Finish
AP8879	60mm	Chrome

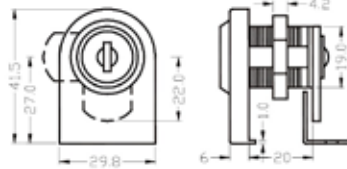

CAM LOCK - FOR HINGED DOORS

Part No.	Finish
AP8843	Chrome

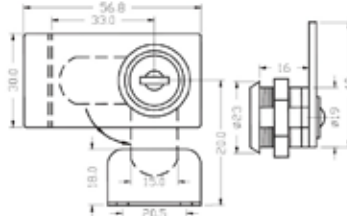

CAM LOCK - FOR DOUBLE HINGED DOORS

Part No.	Finish
AP8845	Chrome





LED STRIP LIGHTING

- At last, a comprehensive range of convenient systems for mounting LED lights into showcases, cabinets or any application.
- Select aluminium base, then the cover strip according to the effect required and then the LED lighting strip.



ALUMINIUM DIRECT MOUNTING STRIP

- For attaching directly to surface – use countersunk screws or double-sided tape.

Part No.	Length	Finish
AP8853M	2400mm	Mill Finish

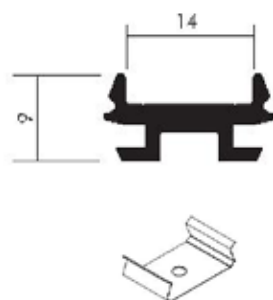

CLIP-ON MOUNTING STRIP

- Use with stainless steel clips (see below).
- Provides easier mounting and detachable option for on-site assembly.

Part No.	Length	Finish
AP8859M	2400mm	Mill Finish
AP8859CUP	10mm	Stainless Steel

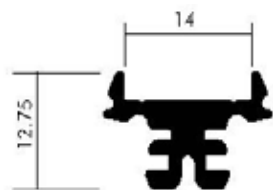

SHOWCASE INFILL LED STRIP

- Slides into angled section on inside of frame profiles.

Part No.	Length	Finish
AP8858	2400mm	Mill Finish



FLAT DIFFUSER PROFILE

- Clips onto aluminium light strips.
- Protects LED's and provides light diffusion.

Part No.	Length	Finish
AP8880CLR	2400mm	Clear
AP8880OPL	2400mm	White Opal

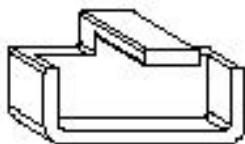

PLASTIC END CAPS

- To suit Flat Diffuser profile.
- The finishing touch for use with clip-on aluminium mounting strip and diffuser.

Part No.	Finish
AP8882GY	Grey



RADIUS DIFFUSER PROFILE

- Clips onto aluminium light strips.
- Protects LED's and provides light diffusion.

Part No.	Length	Finish
AP8881CLR	2400mm	Clear
AP8881OPL	2400mm	White Opal

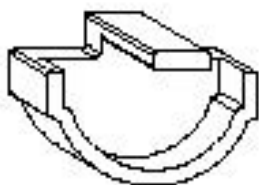

PLASTIC END CAPS

- To suit Radius Diffuser profile.
- The finishing touch for use with clip-on aluminium mounting strip and diffuser.

Part No.	Finish
AP8868	Grey



LED LIGHTING STRIP

- Flexible, self-adhesive strip with a choice of lighting intensity.
- 120 Bulbs per metre.
- 14.4 Watts per metre.
- High quality - 24V.

Part No.	Length	Finish
AP7995/5M	5000mm	5000K Cool White



LED DRIVERS

- 24V system.

Part No.	Watts
AP40851	96W



LED SPOTLIGHT TRACK SYSTEM

- Low profile track can be surface mounted or recessed into cabinetry.
- Allows for simple positioning of high intensity mini-spotlamps.



TRACK

- 12V system with 3 track electric.
- Lead on one end to connect to LED driver.
- Includes end caps that conceal routed slot ends.
- Available in Black or White.

Part No.	Length	Finish
AP8895/18BK	1800mm*	Black
AP8895/18WH	1800mm*	White

* May be trimmed to length.

* Other lengths available to special order.



MINI SPOTLIGHT

- Polished chrome fitting swivels in all directions.

Part No.	Finish
AP8898	Polished Chrome



LED DRIVER

- 12V system.
- Allows for up to 6 spotlights per track.

Part No.	Watts
AP8897	48W

2-STAGE DRILL BIT

- Use as a stop for hinged doors or as a flush top support for counter glass tops.

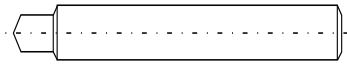
**Part No.****AP8872****REBATING ROUTER BIT**

- Use to cover side frame of sliding doors or to take 18mm thick timber panels.

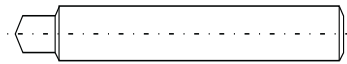
**Part No.****AP8874****CORNER DRILLING JIG**

- For cast corner connectors. Mounts to table of drill press.

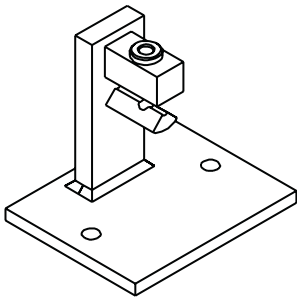
**Part No.****AP8876****BEAM LOCK DRILLING JIG**

- For beam locks. Mounts to table of drill press.

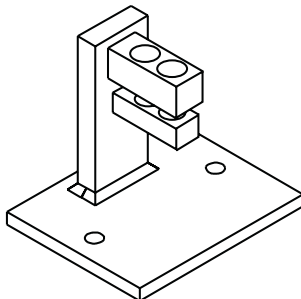
**Part No.****AP8875****HAND PUNCH**

- For accurate beam lock holes and burr free.

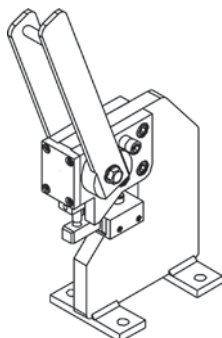

GLASS TOP SPECIFICATIONS

OPTION 1

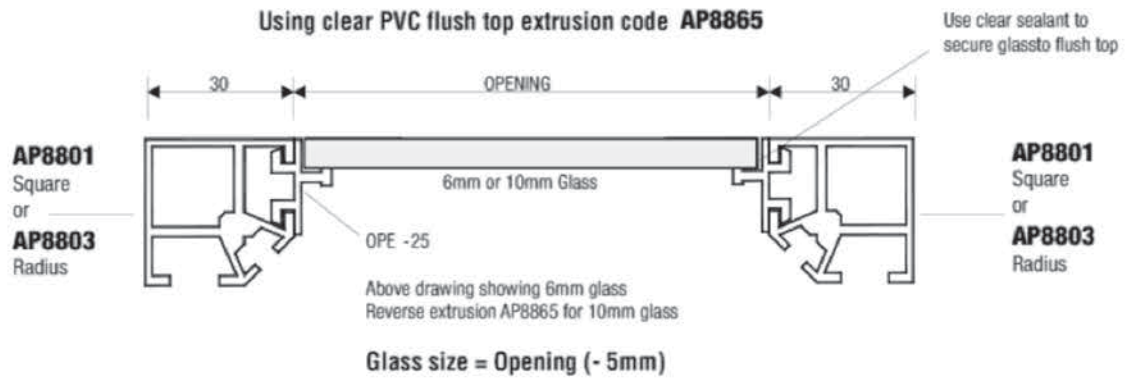

OPTION 2

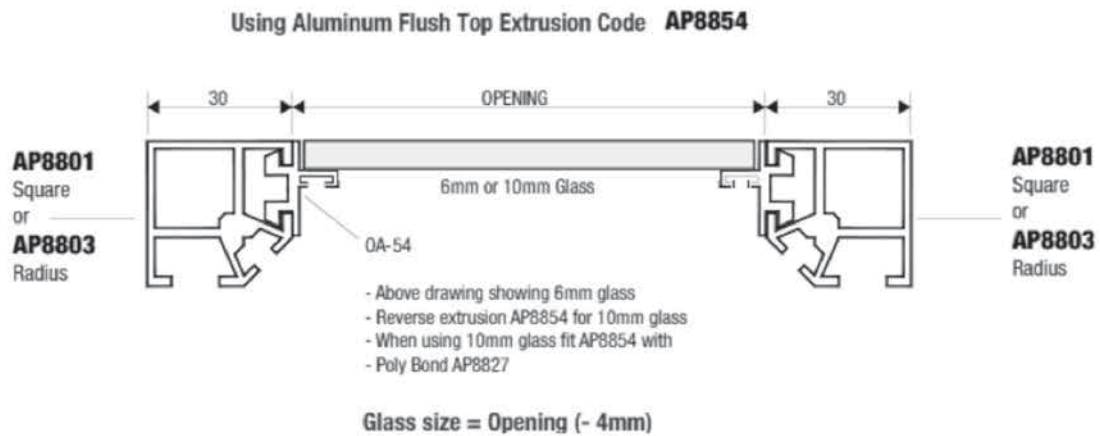

OPTION 3

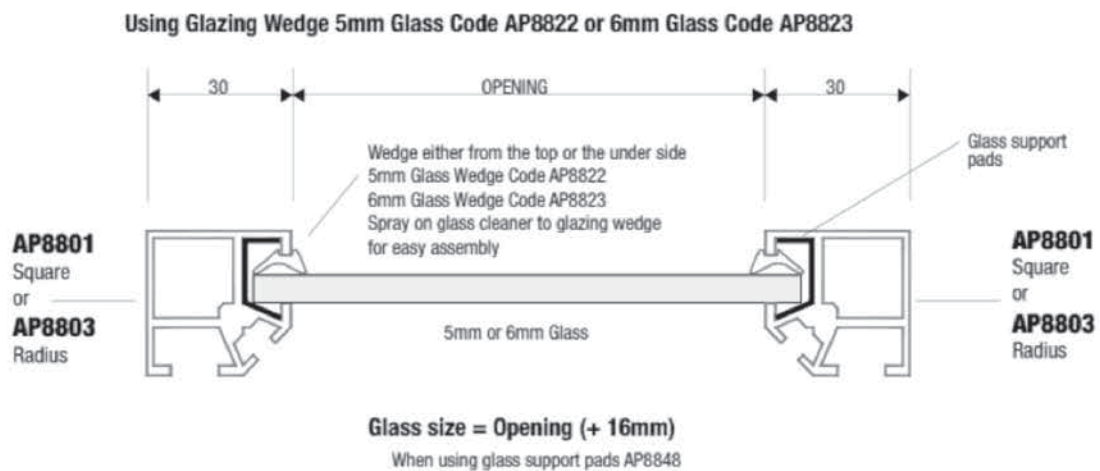

Available in Grey(GY), White(WH) & Black(BL)

30

OPENING

30

Glass support pads
AP8848
(for glass panels only)

AP8801
Square
or
AP8803
Radius

Spray on glass cleaner to glazing
wedge for easy assembly

5mm or 6mm Glass

AP8801
Square
or
AP8803
Radius

9mm MDF panels
can be used

Above drawing showing plan view of side panels

Glass size = Opening (+ 16mm)
When using glass support pads AP8848
MDF Panels = Opening (+ 18mm)

9mm MDF panels
can be used

AP8801 - Square or AP8803 - Radius

30

Refer to Glass Top Specification options

Glass or MDF side panel opening Height and Width (+16mm) for glass (+18mm) for MDF

OPENING HEIGHT

Glass support pads AP8848

30

AP8801 Square or AP8803 Radius

MDF 9mm Base shelf opening (+18mm)

Kick MDF 18mm opening (-2mm)

40

20

OPENING

AP8801 - Square or AP8803 - Radius

30

Refer to Glass Top Specification options

Glass or MDF side panel opening Height and Width (+16mm) for glass (+18mm) for MDF

OPENING HEIGHT

MDF 12mm Base shelf opening (-2mm) bevel corners 10x10 To use 18mm thick base shelf reverse AP8805 beam

40

20

OPENING

Typical Cross Sections

Note AP8848 use for glass panels only not required for MDF panels

GLASS SHELF SPECIFICATIONS

DESIGN OPTION 1

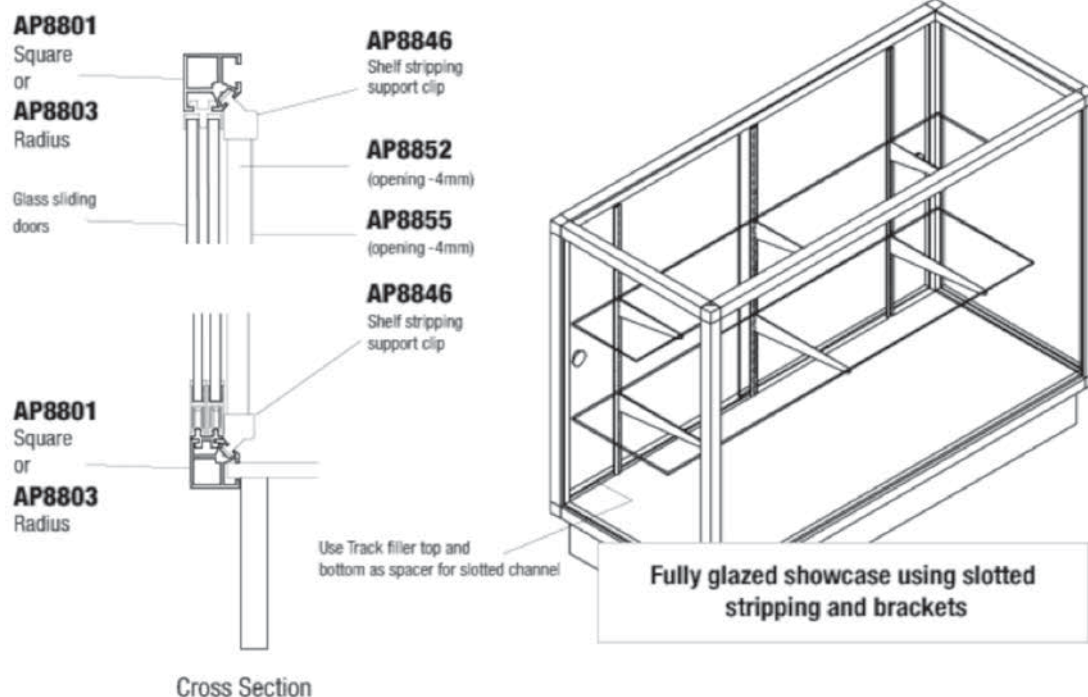

DESIGN OPTION 2

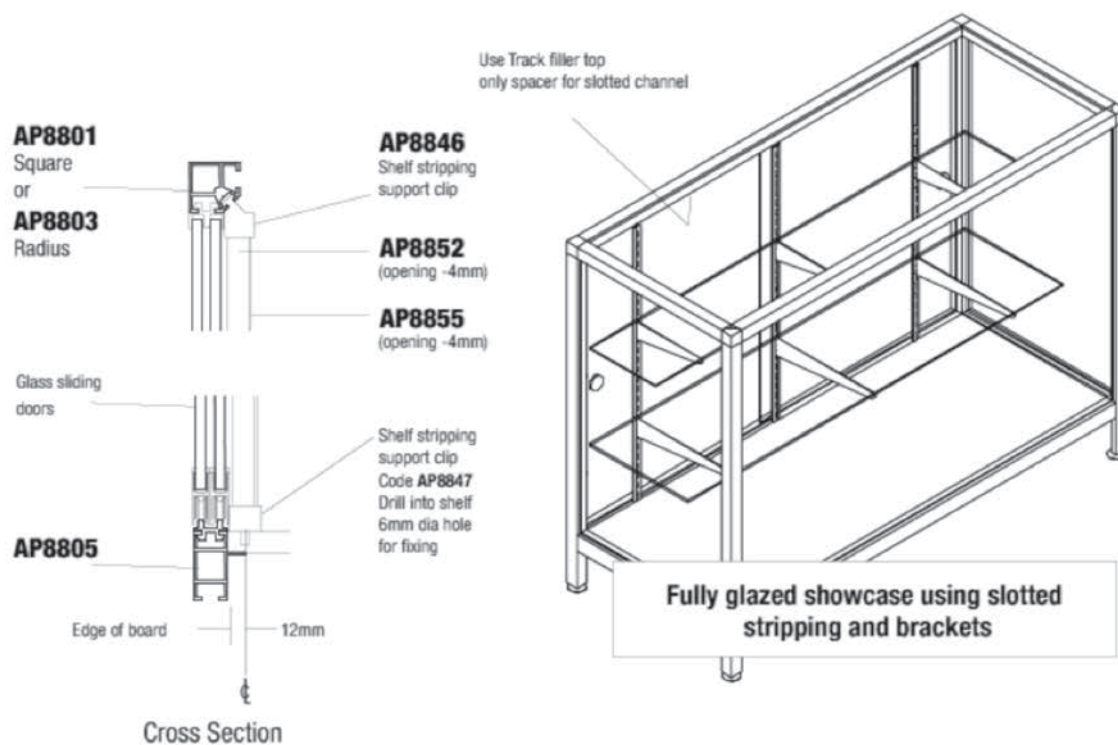

Available in Grey(GY), White(WH) & Black(BL)

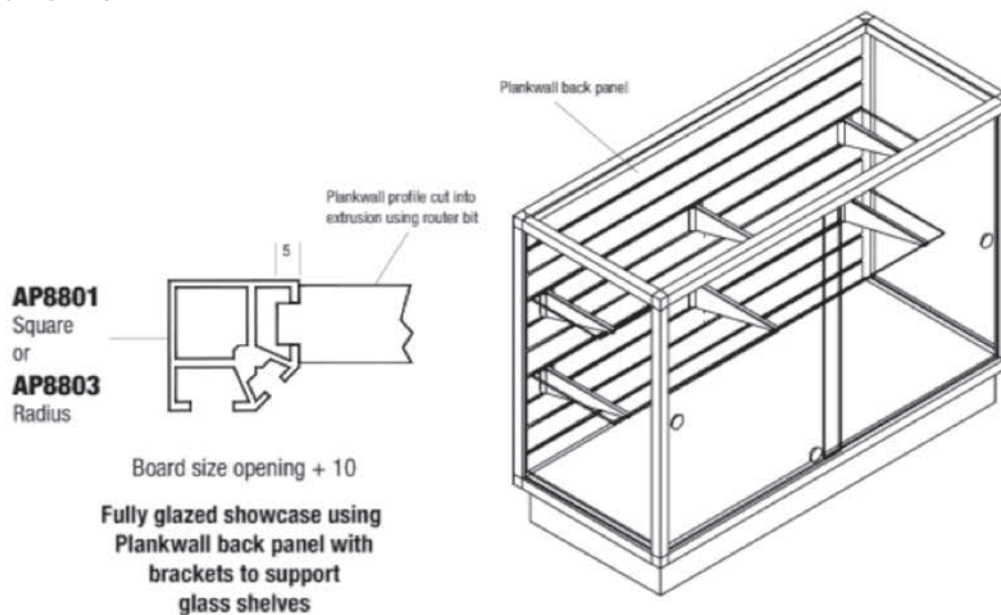
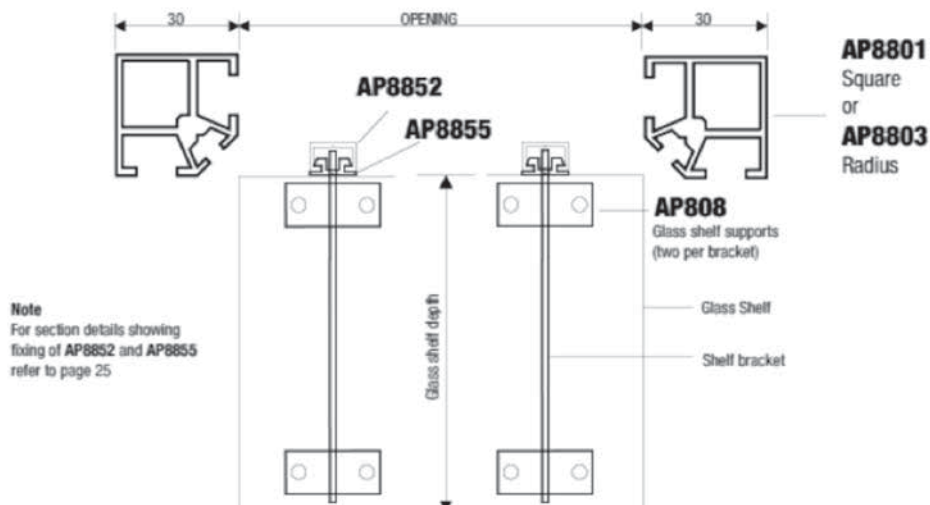
GLASS SHELF SPECIFICATIONS**DESIGN OPTION 1****OPTION 1****OPTION 2**

GLASS SLIDING DOOR SPECIFICATIONS
OPTION 1 - ROLLER TRACK ALUMINIUM

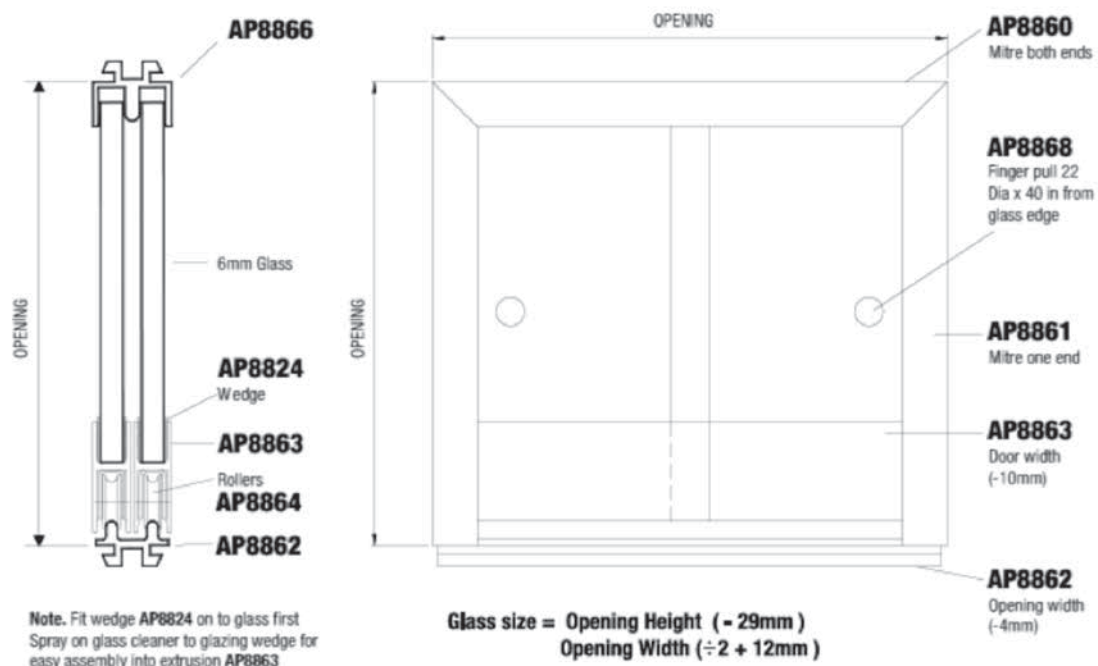

OPTION 2 - SLIDING ALUMINIUM OR PVC DOOR TRACK

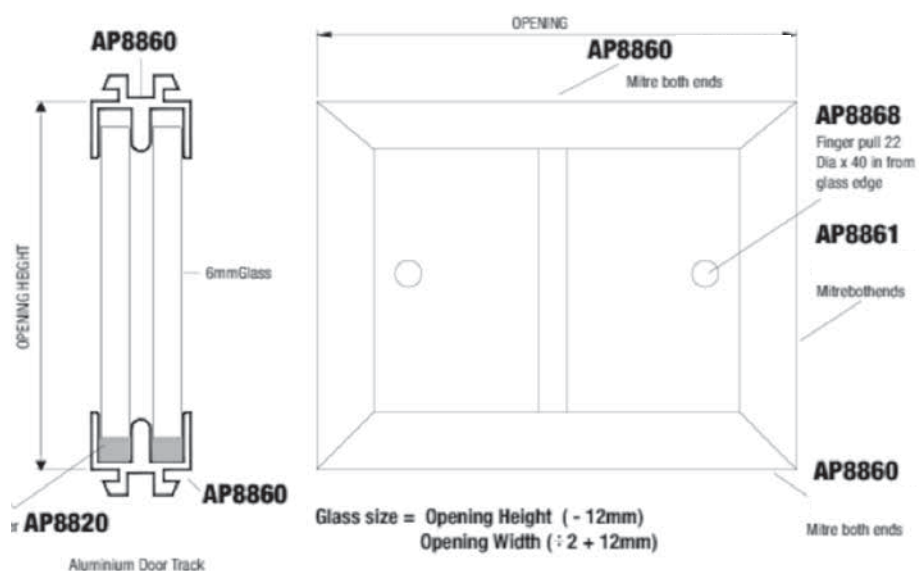

Available in Grey(GY), White(WH) & Black(BL)

AP8854
Door stop with AP8827 polybond (opening -3)
Place in 10mm position

AP8841
Glass Door Hinge

AP8856

Section A

AP8801
Square
or
AP8803
Radius

AP8856

AP8805
as drawn

AP8801 or AP8803
can also be used
this way to take
door hinge

Section B

AP8843 19mm dia. hole

19mm dia hole

Drill for hinge pin
8mm Dia hole through
track filler on centre line of
AP8856

Glass size = Opening Height (- 12mm)
Opening Width (- 8mm)

Door details for both glass and MDF storage doors

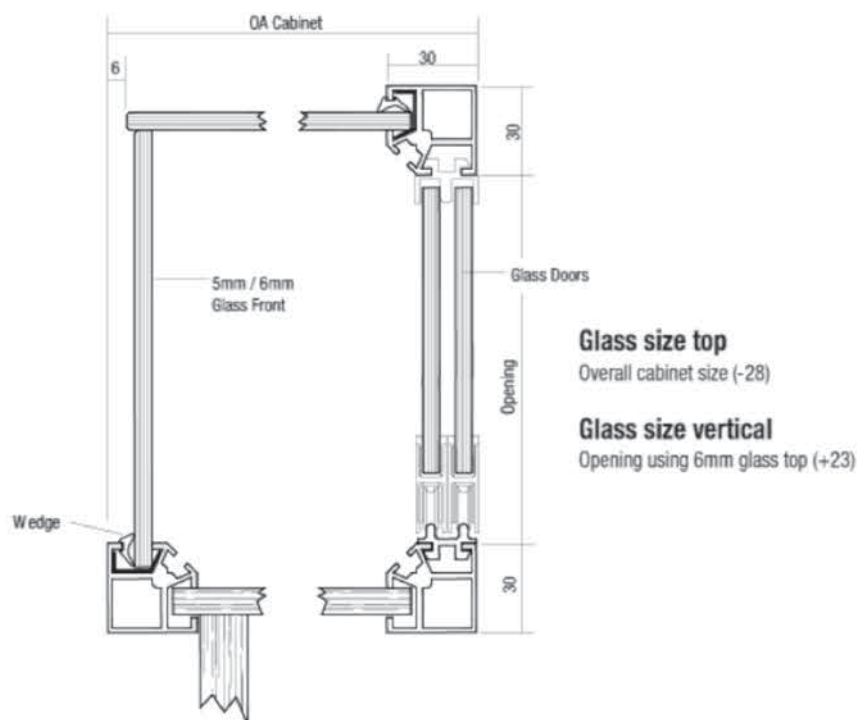
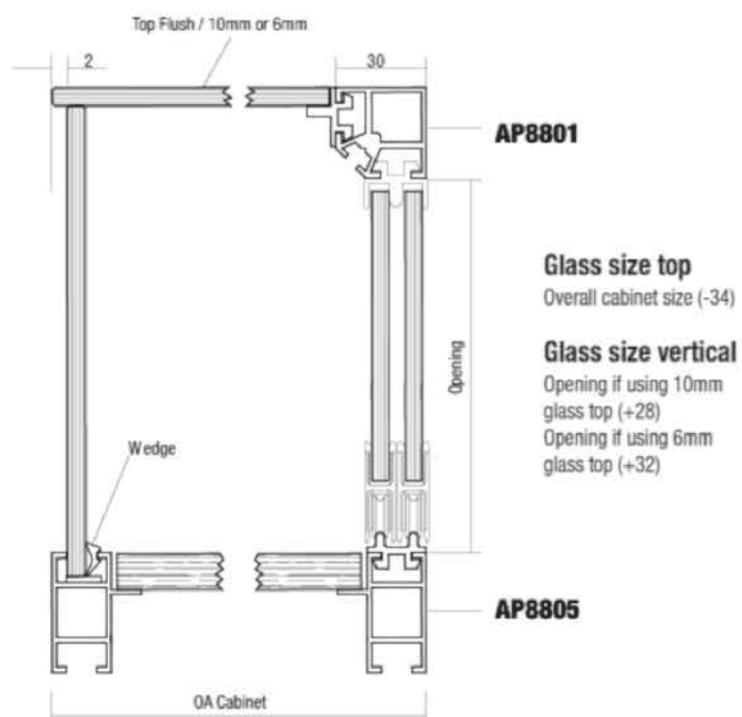
FRAMELESS TOP FRONT DETAIL**GLASS TOP - NO FRONT EXTRUSION WITH WEDGE TOP****GLASS TOP - NO FRONT EXTRUSION WITH WEDGE TOP**

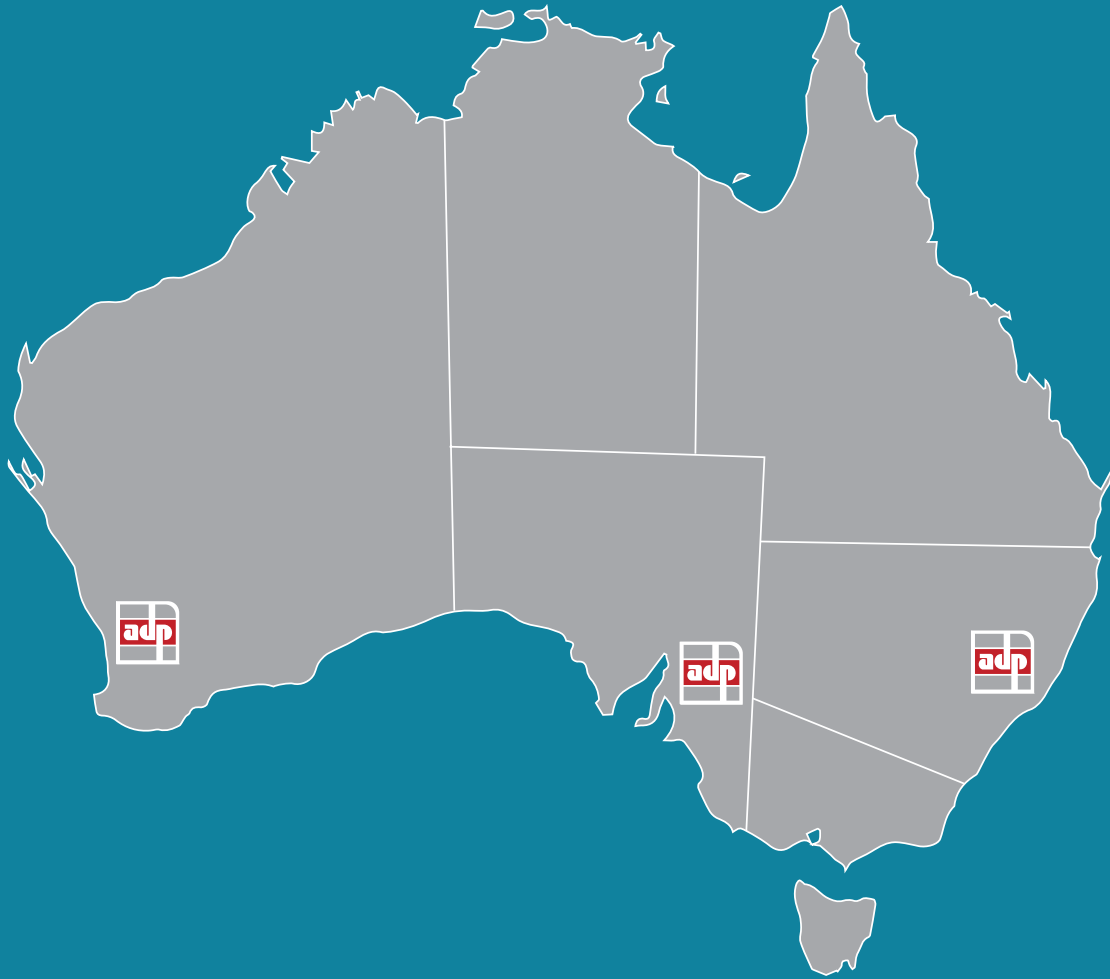

CONTACT US TODAY:

PERTH - Showroom & Warehouse

33 Tamara Drive, Cockburn Central, WA 6164
PO Box 5132, South Lake, WA 6164

P: (08) 9411 0999 **F:** (08) 9414 9484

National Freecall: 1800 642 366

E: sales@adpstore.com.au

ADELAIDE - Showroom & Warehouse

255 Richmond Road, Richmond, SA 5033

P: (08) 8351 9032 **F:** (08) 8351 9035

E: showroom@adpstore.com.au

SYDNEY - Warehouse Only

U44, 14 Loyalty Road, North Rocks, NSW 2151

P: 1800 642 366

E: sales@adpstore.com.au